

PARTICLE AND DIRT SEPARATORS

SPIROTRAP®



Industry leading
up to 20-years guarantee



High-efficient
dirt separation



Energy saving



Safe, high-powered
magnet



Constant,
low pressure drop



Quick and easy
cleaning



All images used are for illustrative purposes only. Individual features like material used (i.e. brass or steel) may vary, as may guarantee.

SPIROTRAP®



BENEFITS OF SPIROTRAP

- Very small particles, from 5 µm (= 0.005 mm) are separated and removed
- Dirt can be drained while the system is in operation
- No shut-off valves or bypass required
- Constant low pressure drop
- Maintenance only takes a few seconds and is not a dirty job compared to a filter solution
- No unnecessary downtime
- Connection diameters from ¾" to DN 800 (see page 30 for additional options)
- A complete range, suitable for various pressures and temperatures

SPIROTRAP PARTICLE AND DIRT SEPARATORS

Today's highly energy-efficient heating and cooling systems can only offer optimal performance with dirt-free water. In untreated systems, dirt can accumulate in multiple places throughout the system. Studies and practical experience show that magnetite in particular, leads to greatly reduced energy efficiency and therefore higher energy costs. Ensuring quick and efficient dirt removal is essential. Spirotech offers an extensive range of SpiroTrap dirt separators from small brass solutions to heavy duty steel units, specifically designed for the removal of dirt.

AVAILABLE VERSIONS:

- Normal flow brass (designed for a nominal flow velocity up to 1 m/s)
- Normal flow steel (designed for a nominal flow velocity up to 1.5 m/s)
- Hi-flow (designed for a nominal flow velocity up to 3 m/s)
- Magnetic (separators with internal or external magnet)
- Demountable (If the level of contamination is such that it needs to be possible to replace or clean the separating element).



MAXIMISING PERFORMANCE – PROTECT COMPONENTS WITH SPIROTRAP MB3/MBL

The unique magnetic field booster technology guarantees fast and optimal dirt separation. Beside non-magnetic dirt even the smallest magnetite particles are removed, maximising system performance as well as protecting costly system components.

Thanks to the ingenious design, collected dirt can be removed quickly and easily. The sturdy brass SpiroTrap MB3 and SpiroTrap MBL are equipped with a swivel connection that makes them very easy to install and suitable for horizontal, vertical and even diagonal pipes. The units with compression couplings have a unique slide-over installation, allowing for quick and easy installation in existing systems.

For connections from 1¼" up to 2", we offer the SpiroTrap MBL. For even larger applications, we recommend our SpiroTrap Magnet (in steel).

Kiwa GASTEC has objectively proven that Spirotech's SpiroTrap MB3, which maximises magnetite removal, can bring up to 7.4 % energy savings.



SPIROTRAP®

Brass solution

SPIROTRAP® MBC – Brass solution with universal connection

Art.-No.	Con- nection d	int.	Hv	Hh	D	L	M	Nom. flow rate	Nom. flow rate	Δp at nom. flow	Volume	Weight
			[mm]	[mm]	[mm]	[mm]	[mm]	[m³/h]	[l/s]	[kPa]	[ltr]	[kg]
UE022WH	22 mm	-	150	121	73	120	110	1,30	0,36	2,1	0,2	1,4
UE028WH	28 mm	-	150	121	83	120	121	2,00	0,56	3,8	0,3	1,6
UE075WH	Rp¾	(F)	140	121	73	100	112	1,30	0,36	2,1	0,2	1,4
UE100WH	Rp1	(F)	140	121	83	100	124	2,00	0,56	3,8	0,3	1,6



Op. pressure
max. 10 bar



Temperature
max. 110 °C



Nom. flow velocity
1 m/s



with magnet

SPIROTRAP® MB3/MBL – Brass solution with universal connection

Art.-No.	Con- nection d	int.	Hv	Hh	D	L	b	B	h	h1	x	y	e	ext.	Nom. flow rate	Nom. flow rate	Δp at nom. flow	Volume	Weight
			[mm]	[mm]	[mm]	[mm]	[mm]	[mm]	[mm]	[mm]	[mm]	[mm]	[mm]		[m³/h]	[l/s]	[kPa]	[ltr]	[kg]
UE022WJ	22 mm	-	177	149	84	112	123	141	117	32	>110	>50	G¾	(M)	1,30	0,36	2,1	0,4	2,2
UE028WJ	28 mm	-	177	149	84	112	127	149	117	32	>110	>50	G¾	(M)	2,00	0,56	3,8	0,4	2,3
UE075WJ	Rp¾	(F)	162	149	84	90	125	142	117	32	>110	>50	G¾	(M)	1,30	0,36	2,1	0,4	2,2
UE100WJ	Rp1	(F)	162	149	84	90	129	152	117	32	>110	>50	G¾	(M)	2,00	0,56	3,8	0,4	2,3
UE125WJ	Rp1¼	(F)	224	210	84	128	138	163	160	50	>110	>50	G¾	(M)	3,60	1,00	2,2	0,8	3,6
UE150WJ	Rp1½	(F)	224	210	84	128	141	168	160	50	>110	>50	G¾	(M)	5,00	1,39	2,6	0,8	3,7
UE200WJ	Rp2	(F)	224	210	84	128	148	183	160	50	>110	>50	G¾	(M)	7,50	2,08	5,8	0,8	3,9



Op. pressure
max. 10 bar



Temperature
max. 110 °C



Nom. flow velocity
1 m/s



with magnet

SPIROTRAP® – Brass solution with horizontal connection

Art.-No.	Con- nection d	int.	H	D	L	b	B	h	h1	x	y	e	ext.	Nom. flow rate	Nom. flow rate	Δp at nom. flow	Volume	Weight
			[mm]	[mm]	[mm]	[mm]	[mm]	[mm]	[mm]	[mm]	[mm]	[mm]		[m³/h]	[l/s]	[kPa]	[ltr]	[kg]
AE022	22 mm	-	118	65	106	-	-	96	22	>70	>50	G¾	(M)	1,30	0,36	1,3	0,2	1,2
AE075	G¾	(F)	118	65	85	-	-	96	22	>70	>50	G¾	(M)	1,30	0,36	1,3	0,2	1,0
AE100	G1	(F)	143	65	88	-	-	108	35	>70	>50	G¾	(M)	2,00	0,56	1,3	0,2	1,3
AE125	G1¼	(F)	161	65	88	-	-	122	39	>70	>50	G¾	(M)	3,60	1,00	1,3	0,3	1,4
AE150	G1½	(F)	197	65	88	-	-	155	42	>70	>50	G¾	(M)	5,00	1,39	1,3	0,3	1,6
AE200	G2	(F)	240	65	132	-	-	180	60	>70	>50	G¾	(M)	7,50	2,08	1,4	1,1	3,9



Op. pressure
max. 10 bar



Temperature
max. 110 °C



Nom. flow velocity
1 m/s



with magnet

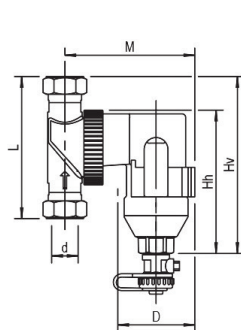

SPIROTRAP
MBC

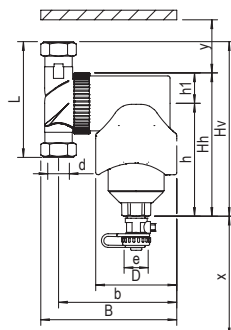

SPIROTRAP
MB3

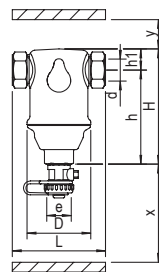

SPIROTRAP
HORIZONTAL



Have you thought of an automatic air vent (AAV) and microbubble deaeration? Learn more on page 15.

CUSTOM

Please visit page 30 for further information on our custom products.

SPIROTRAP®

Brass solution

ACCESSORIES

SPIROTRAP® – Accessories for brass solution

Art.-No.	Description	Suitable for
TAR200	Insulation Set SpiroTrap for 2" horizontal connection	AE200
TAE150	Insulation Set SpiroTrap for horizontal connection	AE022, AE075, AE100, AE125, AE150
TUR100	Insulation Set SpiroTrap MB3 for universal connection	UE022WJ, UE028WJ, UE075WJ, UE100WJ
TUR125	Insulation Set SpiroTrap Rp1¼	UE125WJ
TUR150	Insulation Set SpiroTrap Rp1½	UE150WJ
TUR200	Insulation Set SpiroTrap Rp2	UE200WJ

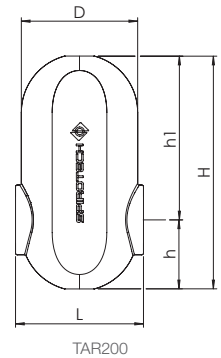

SPIROTRAP®

Steel solution

STANDARD

SPIROTRAP® – Steel solution with magnet – standard flow

Art.-No.	DN	OD	H	D	L/LF	h	h1	x	xr	y	e	int.	Nom. flow rate [m³/h]	Nom. flow rate [l/s]	Δp at nom. flow [kPa]	Volume [ltr]	Weight [kg]
		[mm]	[mm]	[mm]	[mm]	[mm]	[mm]	[mm]	[mm]	[mm]	[mm]						
BE050LM	50	60,3	471	159	260	341	121	>75	330	>50	Rp1	(F)	12,50	3,47	3,0	5,0	8,0
BE050FM	50	60,3	471	159	350	341	121	>75	330	>50	Rp1	(F)	12,50	3,47	3,0	5,0	13,0
BE065LM	65	76,1	471	159	260	333	129	>75	330	>50	Rp1	(F)	20,00	5,56	2,9	5,0	8,0
BE065FM	65	76,1	471	159	350	333	129	>75	330	>50	Rp1	(F)	20,00	5,56	2,9	5,0	14,0
BE080LM	80	88,9	576	219	370	424	148	>100	370	>50	Rp1	(F)	27,00	7,50	3,1	17,0	16,0
BE080FM	80	88,9	576	219	470	424	148	>100	370	>50	Rp1	(F)	27,00	7,50	3,1	17,0	24,0
BE100LM	100	114,3	576	219	370	412	160	>100	370	>50	Rp1	(F)	47,00	13,06	3,7	17,0	16,0
BE100FM	100	114,3	576	219	475	412	160	>100	370	>50	Rp1	(F)	47,00	13,06	3,7	17,0	25,0
BE125LM	125	139,7	798	324	525	605	193	>100	540	>50	Rp1	(F)	72,00	20,00	4,2	50,0	47,0
BE125FM	125	139,7	798	324	635	605	193	>100	540	>50	Rp1	(F)	72,00	20,00	4,2	50,0	58,0
BE150LM	150	168,3	798	324	525	591	207	>100	540	>50	Rp1	(F)	108,00	30,00	4,9	50,0	48,0
BE150FM	150	168,3	798	324	635	591	207	>100	540	>50	Rp1	(F)	108,00	30,00	4,9	50,0	61,0
BE200FM	200	219,1	1.063	406	775	773	280	>100	700	>50	Rp1	(F)	180,00	50,00	5,8	105,0	107,0
BE250FM	250	273,0	1.265	508	890	896	364	>100	750	>50	Rp2	(F)	288,00	80,00	7,0	210,0	162,0
BE300FM	300	323,9	1.492	610	1.005	1.058	426	>100	900	>50	Rp2	(F)	405,00	112,50	7,8	350,0	261,0



Op. pressure
max. 10 bar



Temperature
max. 110 °C



Nom. flow velocity
1.5 m/s



with Magnet

L = Weld ends / F = Flange design (PN 16) / M = Magnet

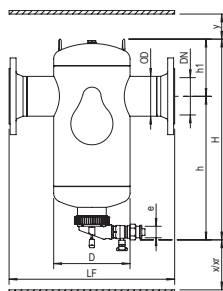

SPIROTRAP
FLANGE DESIGN

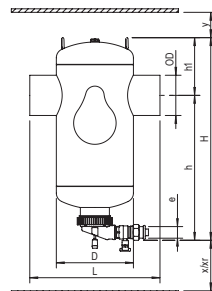

SPIROTRAP
WELD ENDS DESIGN

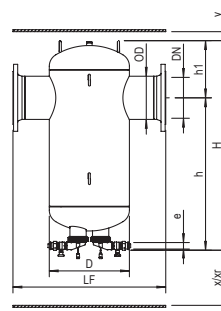

SPIROTRAP
FLANGE DESIGN
FROM DN 200



Have you also thought of an automatic air vent/microbubble separator? Learn more on page 15.

SPIROTRAP®

Steel solution

STANDARD

SPIROTRAP® – Steel solution – standard flow

Art.-No.	DN	OD	H	D	L/LF	h	h1	x	y	e	int.	Nom. flow rate	Nom. flow rate	Δp at nom. flow	Volume	Weight
		[mm]	[mm]	[mm]	[mm]	[mm]	[mm]	[mm]	[mm]	[mm]		[m³/h]	[l/s]	[kPa]	[ltr]	[kg]
BE050L	50	60,3	390	159	260	270	121	>200	>50	Rp1	(F)	12,50	3,47	3,0	5,0	9,0
BE050F	50	60,3	390	159	350	270	121	>200	>50	Rp1	(F)	12,50	3,47	3,0	5,0	13,0
BE065L	65	76,1	390	159	260	260	129	>200	>50	Rp1	(F)	20,00	5,56	2,7	5,0	9,0
BE065F	65	76,1	390	159	350	260	129	>200	>50	Rp1	(F)	20,00	5,56	2,7	5,0	15,0
BE080L	80	88,9	500	219	370	355	148	>200	>50	Rp1	(F)	27,00	7,50	2,9	17,0	17,0
BE080F	80	88,9	500	219	470	355	148	>200	>50	Rp1	(F)	27,00	7,50	2,9	17,0	25,0
BE100L	100	114,3	500	219	370	345	160	>200	>50	Rp1	(F)	47,00	13,06	3,7	17,0	17,0
BE100F	100	114,3	500	219	475	345	160	>200	>50	Rp1	(F)	47,00	13,06	3,7	17,0	26,0
BE125L	125	139,7	670	324	525	475	193	>200	>50	Rp1	(F)	72,00	20,00	4,2	50,0	41,0
BE125F	125	139,7	670	324	635	475	193	>200	>50	Rp1	(F)	72,00	20,00	4,2	50,0	54,0
BE150L	150	168,3	670	324	525	460	207	>200	>50	Rp1	(F)	108,00	30,00	4,9	50,0	42,0
BE150F	150	168,3	670	324	635	460	207	>200	>50	Rp1	(F)	108,00	30,00	4,9	50,0	56,0
BE200F	200	219,1	900	406	775	615	280	>200	>50	Rp1	(F)	180,00	50,00	5,8	105,0	105,0
BE250F	250	273,0	1.165	508	890	800	364	>200	>50	Rp2	(F)	288,00	80,00	6,9	210,0	170,0
BE300F	300	323,9	1.380	610	1.005	955	426	>200	>50	Rp2	(F)	405,00	112,50	7,7	350,0	252,0



Op. pressure
max. 10 bar



Temperature
max. 110 °C



Nom. flow velocity
1.5 m/s



without magnet

Products in the range are available up to DN800 and are made to order – prices on application.

L = Weld ends / F = Flange design (PN 16)

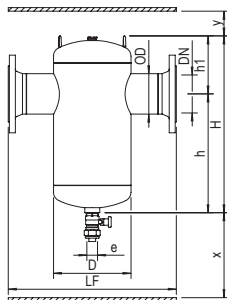

SPIROTRAP
FLANGE DESIGN

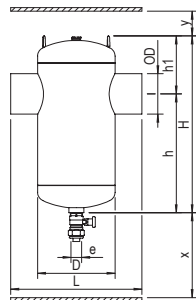

SPIROTRAP
WELD ENDS

SPIROTRAP®

Steel solution

SPIROTRAP® – Demountable steel solution – standard flow

SPECIAL

Art.-No.	DN	OD	H	D	L/LF	DF	h	h1	x	y	e	int.	Nom. flow rate	Nom. flow rate	Δp at nom. flow	Volume	Weight
		[mm]	[mm]	[mm]	[mm]	[mm]	[mm]	[mm]	[mm]	[mm]	[mm]		[m³/h]	[l/s]	[kPa]	[ltr]	[kg]
BF050L	50	60,3	390	159	260	285	270	121	>350	>50	Rp1	(F)	12,50	3,47	3,0	5,0	28,0
BF050F	50	60,3	390	159	350	285	270	121	>350	>50	Rp1	(F)	12,50	3,47	3,0	5,0	33,0
BF065L	65	76,1	390	159	260	285	260	129	>350	>50	Rp1	(F)	20,00	5,56	2,7	5,0	28,0
BF065F	65	76,1	390	159	350	285	260	129	>350	>50	Rp1	(F)	20,00	5,56	2,7	5,0	34,0
BF080L	80	88,9	500	219	370	340	355	148	>500	>50	Rp1	(F)	27,00	7,50	2,9	17,0	40,0
BF080F	80	88,9	500	219	470	340	355	148	>500	>50	Rp1	(F)	27,00	7,50	2,9	17,0	48,0
BF100L	100	114,3	500	219	370	340	345	160	>500	>50	Rp1	(F)	47,00	13,06	3,7	17,0	40,0
BF100F	100	114,3	500	219	475	340	345	160	>500	>50	Rp1	(F)	47,00	13,06	3,7	17,0	50,0
BF125L	125	139,7	670	324	525	460	475	193	>600	>50	Rp1	(F)	72,00	20,00	4,2	50,0	90,0
BF125F	125	139,7	670	324	635	460	475	193	>600	>50	Rp1	(F)	72,00	20,00	4,2	50,0	103,0
BF150L	150	168,3	670	324	525	460	460	207	>600	>50	Rp1	(F)	108,00	30,00	4,9	50,0	90,0
BF150F	150	168,3	670	324	635	460	460	207	>600	>50	Rp1	(F)	108,00	30,00	4,9	50,0	106,0
BF200F	200	219,1	900	406	775	580	615	280	>900	>50	Rp1	(F)	180,00	50,00	5,8	105,0	195,0
BF250F	250	273,0	1.165	508	890	715	800	364	>1,100	>50	Rp2	(F)	288,00	80,00	6,9	210,0	319,0
BF300F	300	323,9	1.380	610	1.005	840	955	426	>1,300	>50	Rp2	(F)	405,00	112,50	7,7	350,0	499,0



Op. pressure
max. 10 bar



Temperature
max. 110 °C



Nom. flow velocity
1.5 m/s



without magnet

L = Weld ends / F = Flange design (PN 16)

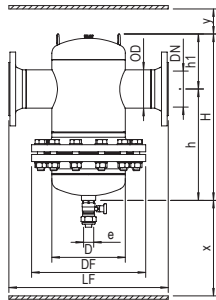

SPIROTRAP
DEMOUNTABLE
FLANGE DESIGN

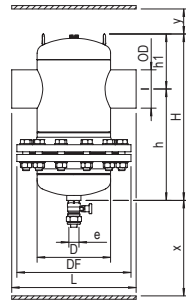

SPIROTRAP
DEMOUNTABLE
WELD ENDS

CUSTOM

Please visit page 30 for further information on our custom products.

SPIROTRAP®

Steel solution

SPIROTRAP® – Steel solution – Hi-flow

SPECIAL

Art.-No.	DN	OD	H	D	L/LF	h	h1	x	y	e	int.	Nom. flow rate	Nom. flow rate	Δp at nom. flow	Volume	Weight
												[m³/h]	[l/s]			
HE050L	50	60,3	550	159	260	430	121	>200	>50	Rp1	(F)	25,00	6,94	11,7	7,0	12,0
HE050F	50	60,3	550	159	350	430	121	>200	>50	Rp1	(F)	25,00	6,94	11,7	7,0	17,0
HE065L	65	76,1	550	159	260	420	129	>200	>50	Rp1	(F)	40,00	11,11	11,9	7,0	12,0
HE065F	65	76,1	550	159	350	420	129	>200	>50	Rp1	(F)	40,00	11,11	11,9	7,0	18,0
HE080L	80	88,9	700	219	370	550	148	>200	>50	Rp1	(F)	54,00	15,00	12,4	25,0	23,0
HE080F	80	88,9	700	219	470	550	148	>200	>50	Rp1	(F)	54,00	15,00	12,4	25,0	31,0
HE100L	100	114,3	700	219	370	540	160	>200	>50	Rp1	(F)	94,00	26,11	14,7	25,0	24,0
HE100F	100	114,3	700	219	475	540	160	>200	>50	Rp1	(F)	94,00	26,11	14,7	25,0	33,0
HE125L	125	139,7	950	324	525	755	193	>200	>50	Rp1	(F)	144,00	40,00	16,9	75,0	58,0
HE125F	125	139,7	950	324	635	755	193	>200	>50	Rp1	(F)	144,00	40,00	16,9	75,0	71,0
HE150L	150	168,3	950	324	525	740	207	>200	>50	Rp1	(F)	215,00	59,72	19,2	75,0	59,0
HE150F	150	168,3	950	324	635	740	207	>200	>50	Rp1	(F)	215,00	59,72	19,2	75,0	73,0
HE200F	200	219,1	1.240	406	775	955	280	>200	>50	Rp1	(F)	360,00	100,00	23,4	150,0	136,0
HE250F	250	273,0	1.670	508	890	1.300	364	>200	>50	Rp2	(F)	575,00	159,72	27,5	300,0	213,0
HE300F	300	323,9	1.980	610	1.005	1.550	426	>200	>50	Rp2	(F)	810,00	225,00	31,2	500,0	393,0



Op. pressure
max. 10 bar



Temperature
max. 110 °C



Nom. flow velocity
3 m/s



without Magnet

Products in the range are available up to DN800 and are made to order – prices on application.

L = Weld ends / F = Flange design (PN 16)

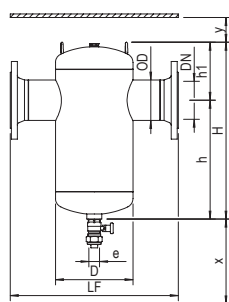

SPIROTRAP
FLANGE DESIGN

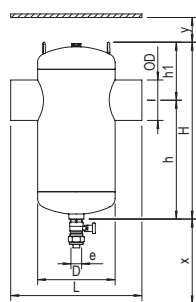

SPIROTRAP
WELD ENDS

CUSTOM

Please visit page 30 for further information on our custom products.

SPIROTRAP®

SPIROTRAP®

Steel solution

SPIROTRAP® – Demountable steel solution – Hi-flow

SPECIAL

Art.-No.	DN	OD	H	D	L/LF	DF	h	h1	x	y	e	int.	Nom. flow rate	Nom. flow rate	Δp at nom. flow	Volume	Weight
		[mm]	[mm]	[mm]	[mm]	[mm]	[mm]	[mm]	[mm]	[mm]	[mm]		[m³/h]	[l/s]	[kPa]	[ltr]	[kg]
HF050L	50	60,3	550	159	260	285	430	121	>500	>50	Rp1	(F)	25,00	6,94	11,7	7,0	30,0
HF050F	50	60,3	550	159	350	285	430	121	>500	>50	Rp1	(F)	25,00	6,94	11,7	7,0	35,0
HF065L	65	76,1	550	159	260	285	420	129	>500	>50	Rp1	(F)	40,00	11,11	11,9	7,0	30,0
HF065F	65	76,1	550	159	350	285	420	129	>500	>50	Rp1	(F)	40,00	11,11	11,9	7,0	36,0
HF080L	80	88,9	700	219	370	340	550	148	>700	>50	Rp1	(F)	54,00	15,00	12,4	25,0	50,0
HF080F	80	88,9	700	219	470	340	550	148	>700	>50	Rp1	(F)	54,00	15,00	12,4	25,0	58,0
HF100L	100	114,3	700	219	370	340	540	160	>700	>50	Rp1	(F)	94,00	26,11	14,7	25,0	50,0
HF100F	100	114,3	700	219	475	340	540	160	>700	>50	Rp1	(F)	94,00	26,11	14,7	25,0	60,0
HF125L	125	139,7	950	324	525	460	755	193	>900	>50	Rp1	(F)	144,00	40,00	16,9	75,0	110,0
HF125F	125	139,7	950	324	635	460	755	193	>900	>50	Rp1	(F)	144,00	40,00	16,9	75,0	123,0
HF150L	150	168,3	950	324	525	460	740	207	>900	>50	Rp1	(F)	215,00	59,72	19,2	75,0	110,0
HF150F	150	168,3	950	324	635	460	740	207	>900	>50	Rp1	(F)	215,00	59,72	19,2	75,0	126,0
HF200F	200	219,1	1.240	406	775	580	955	280	>1.200	>50	Rp1	(F)	360,00	100,00	23,4	150,0	225,0
HF250F	250	273,0	1.670	508	890	715	1.300	364	>1.600	>50	Rp2	(F)	575,00	159,72	27,5	300,0	380,0
HF300F	300	323,9	1.980	610	1.005	840	1.550	426	>1.900	>50	Rp2	(F)	810,00	225,00	31,2	500,0	599,0

Op. pressure
max. 10 bar

Temperature
max. 110 °C

Nom. flow velocity
3 m/s

without Magnet

L = Weld ends / F = Flange design (PN 16)

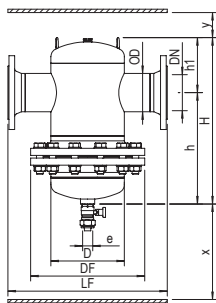

SPIROTRAP
DEMOUNTABLE
FLANGE DESIGN

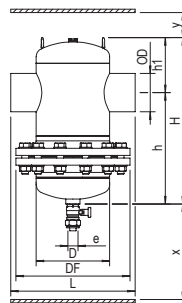

SPIROTRAP
DEMOUNTABLE
WELD ENDS

ACCESSORIES

SPIROTRAP® – Accessories for steel solution

Art.-No.	Description	Suitable for
TB050	Insulation Set for SpiroTrap DN 50 + 65	BE050F/L, BE065F/L, BE050FM/LM, BE065FM/LM
TB080	Insulation Set for SpiroTrap DN 80 + 100	BE080F/L, BE100F/L, BE080FM/LM, BE100FM/LM
TB125	Insulation Set for SpiroTrap DN 125 + 150	BE125F/L, BE150F/L
TB125A01	Insulation Set for SpiroTrap Magnet DN 125 + 150	BE125FM/LM, BE150FM/LM

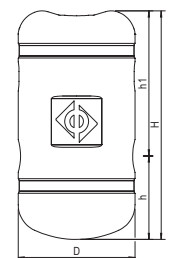

SPIROTRAP
INSULATION

CUSTOM

Please visit page 30 for further information on our custom products.